

THE PERFECT CHOICE FOR QUALITY, AFFORDABLE AND SPACIOUS DREAM COTTAGES.



**HURON
RIDGE** Edition

2019

HURON  **RIDGE**

2019



The Pinnacle of Cottage Living

General Coach Canada started as a small custom manufacturer in Hensall, Ontario and we will never forget our roots. We dream big, *then go bigger*.

At our core, General Coach is family owned and operated, bringing our family values and personal promise to work every day. Whether you are looking at our affordable **FRONTIER** series or our industry leading contemporary **BLACK DIAMOND EDITION**, our emphasis on quality materials and value can be seen in everything we produce.

We don't reflect the industry, **we define it.**

With 68 years of experience, General Coach has manufactured all types of recreational vehicles ranging from motor homes to truck campers and everything in between. What does this mean to you, the customer? It means, you have an experienced team designing and building your dream Park Model Cottage!

RESORT



MANOR



FRONTIER



RESORT SERIES



Floor plans to suit your lifestyle.

The Resort Series is the top of the entire Huron Ridge model line. Large windows and vaulted ceilings provide a

The Ultimate Retreat

At General Coach you can customize your **RESORT** trailer to fit your taste and lifestyle. Whether it's as simple as moving a wall or as complex as designing a unit from scratch, our professional engineering team is up to the task.

STANDARD RESORT SERIES FEATURES

- Modular cabinets throughout the unit
- 5PC cabinet doors and drawers
- Residential rolltop countertops in kitchen and bath
- Stainless steel fridge, stove and OTR microwave
- LED pot lighting package with ceiling fan

OPTIONAL RESORT FEATURES

- Ceramic tile backsplash in kitchen and bath
- Laminate flooring
- 1 1/2" faux wood blinds
- White interior trim package
- Coffered ceilings
- Corian solid surface countertops



bright and spacious feeling as you step through the front door. With 29 floor plans in the Resort line, we're sure you'll find one that suits your lifestyle.

RESORT SERIES



Construction

90" Exterior Sidewall Height
2"x4" Exterior Wall Studding On 16" Centres - R13
2"x8" Transverse Floor Joists on 16" Centres - R20
3/4" T&G Plywood Subfloor Glued & Screwed
4/12 Roof Pitch w/ Engineered Roof Trusses - R20
7/16 OSB Roof Sheathing w/ 15lb Felt Paper
10" Vented Soffit Overhang w/ 2"x6" Fascia Board

Windows & Doors

White Single Hung Vinyl Thermopane Windows - Prairie Grills
White (6') Vinyl Thermopane Patio Door - Prairie Grills
Insulated Aluminum Exterior Door w/ Full Lite - (32")
Aluminum Storm Door w/ Hidden Screen - (32")

Heating & Cooling

40,000BTU Forced Air Furnace w/ Electronic Ignition
Digital Wall Mount Thermostat - Wired For A/C
Heat Duct & Registers Within Insulated Floor Cavity
Prep Only For Basement Air Conditioning Unit

Electrical

50AMP Hydro Service w/ 25' Plug In Cord
(2) Exterior GFCI Receptacle @ Patio & Ent Doors
(2) Exterior Coach @ Patio & Ent Doors - White Lithonia
LED Pot Lights Throughout
LED Pendants over Island - ELENA LPL143A01CH
LED Chandelier over Table - BOKU ICH624A04BN20
LED Vanity - EDDA L719553CH
Decora Receptacles & Light Switches Throughout
Eclipse Ceiling Fan in Living Room

Plumbing

Uponor Propex - Polyethylene Water Lines
ABS Drainage/ Waste Pipes
25Gal Electric Water Heater
Water Heater By-Pass & Low Point Drain

Kitchen & Appliances

S.S. 5.8cuft Self Cleaning Gas Range - JCGB660SEJSS
S.S. Combination OTR Microwave - JVM1635SFC
S.S. 18cuft Refrigerator - GTE18GSHSS
Residential Roll Top Countertops w/ Regency Edge
Double Compartment Stainless Steel Sink
Polished Chrome Single Lever Faucet - Devon
Box Style Modular Cabinets
5 Piece Cabinet Doors w/ Soft Close Hinges
5 Piece Cabinet Doors w/ Metal Box Glides
Satin Nickel Cabinet Door Handles - 8154 SN
Satin Nickel Cabinet Door Handle/Cup - 246 SN

Bathroom Fixtures

Box Style Modular Cabinets w/ Porcelain Sink
54" or 60" Moulded Fiberglass Tub/ Shower
Polished Chrome Diverter, Tub Faucet & Shower Head
Polished Chrome Vanity Faucet - Kai 06-4621P
Polished Chrome Shower Rod w/ Curtain
1.6Gal Low Flush Toilet w/ Insulated Tank - White
70CFM Exhaust Fan
Polished Chrome Towel Bar & Tissue Holder
Polished Chrome Towel Rack Above Toilet
GFCI Receptacle @ Vanity
Medicine Cabinet w/ Mirror On Door

Bedroom Accessories

Wardrobe Closets w/ Drawers & Mirror Doors - MBR
Drawers Below Bottom Bunk - BD#2 & BD#3
6" Spring Mattresses On All Bunks

Interior Décor

2"x3" Interior Wall Construction on 16" Centres
Vinyl Wrapped Drywall Ceiling Throughout
White Colonist Interior Doors Throughout
Satin Nickle Door Knob Hardware Throughout
Durable Woodgrain Vinyl Flooring Throughout
Custom Designed Drapery Throughout Unit - "Boxed"
Day/ Night Shades Throughout Unit
Pre-finished White Wire Shelving/ Closet Rod
3/4" Door & Window Jambs Throughout
1 1/2" Door & Window Casing Throughout
(3) Cabinet Colour Options Available
(5) Interior Décor Packages Available

Exterior Finishes

GENTEK D-5 Vinyl Siding - Driftwood Finish
Colonial Style Shutters - End Walls & Doorside
White Vinyl Soffit & Aluminum Fascia
30Yr Architectural Fiberglass Shingles



Renfrew - 19 (R3914 2BR FL) 540 SQ.FT.



Rosemère - 19 (R4214) 538.9 SQ.FT.



Rutherford - 19 (R3812 1BRFL) 461.2 SQ.FT.

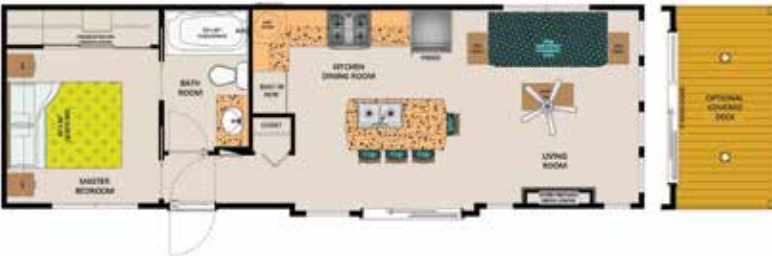

Revelstoke - 19 (R3914 2BR FLD) 538.6 SQ.FT.



Rosedale - 19 (R3914 2BR FL) 540 SQ.FT.



Ramsey - 19 (R3914 1BR) 540 SQ.FT.



Ridgetown 2 - 19 (R4412 2BR FL) 537.7 SQ.FT.



Rustico 2 - 19 (R4412 2BRTL) 537.7 SQ.FT.



Rackerby - 19 (4412) 528 SQ.FT.



Rustico - 19 (R4412 1BRTL) 537.7 SQ.FT.



Radisson - 19 (R4012 1BR FL) 492 SQ.FT.



Riverview - 19 (R4012 2BR FL) 493 SQ.FT.



Rogerville - 19 ((P4728) 540 SQ.FT. + 484 SQ.FT.



Richdale - 19 (R4126) 540 SQ.FT. + 529 SQ.FT.



Richelieu - 19 (R4113 2BR FK) 533 SQ.FT.



Red Deer - 19 (D4113) 536 SQ.FT. + 130 SQ.FT.



Rancheria - 19 (R4313) 516 SQ.FT. + 240 SQ.FT.



Resolute - 19 (R4112) 492 SQ.FT. + 240 SQ.FT.



Rockcliffe - 19 (R4124) 488 SQ.FT. + 240 SQ.FT.



Remington - 19 (R4013) 525 SQ.FT.



Rikerson - 19 (3914 3BR) 540 SQ.FT. + 240 SQ.FT.



Redstone - 19 (R4113) 540 SQ.FT. + 240 SQ.FT.



Raymore - 19 (R4024) 480 SQ.FT. + 480 SQ.FT.



Restorton - 19 (R4224) 504 SQ.FT + 504 SQ.FT.



Ridgeway - 19 (M4013 2BR) 520 SQ.FT.



Ralston - 19 (R4224) 504 SQ.FT. + 506.8 SQ.FT.



Riverside - 19 (R4213) 540 SQ.FT.



MANOR SERIES



Relax and enjoy.

Whether your style is traditional or contemporary, our professional interior design team has developed a series of

The Affordable Choice

The **MANOR** series is our affordable alternative to the Resort line without compromising quality or comfort.

These practical living spaces are move in ready and packed with the comforts of home.

STANDARD MANOR SERIES FEATURES

- LED lighting package
- Thermofoil cabinet doors and drawers throughout
- Vaulted vinyl wrapped drywall ceilings
- Day/Night shades throughout
- Laminate countertops w/snap edge kitchen & bath
- Black Appliance Package w/combination OTR microwave

OPTIONAL MANOR FEATURES

- 27" electrical fireplace with remote
- Built-in queen bed with headboard and drawers
- Comfort height bath vanity and toilet
- Wood beam package
- Walk-in shower with seat



stunning colour and fabric combinations. Any one of our 21 Manor Series floor plans makes the perfect environment to relax and enjoy.

MANOR SERIES



Construction

90" Exterior Sidewall Height
2"x3" Exterior Wall Studding On 16" Centres - R8
2"x8" Transverse Floor Joists on 16" Centres - R12
3/4" T&G Plywood Subfloor Glued & Screwed
4/12 Roof Pitch w/ Engineered Roof Trusses - R12
7/16 OSB Roof Sheathing w/ 15lb Felt Paper
10" Vented Soffit Overhang w/ 2"x6" Fascia Board

Windows & Doors

White Single Hung Vinyl Thermopane Windows - Colonial
White (6') Vinyl Thermopane Patio Door - No Grill Insulated
Aluminum Exterior Door w/ 9 Lite - (32")
Aluminum Storm Door w/ Screen - (32")

Heating & Cooling

40,000BTU Forced Air Furnace w/ Electronic Ignition
Analog Wall Mount Thermostat - Wired For A/C
Heat Duct & Registers Within Insulated Floor Cavity
Prep Only For Basement Air Conditioning Unit

Electrical

30AMP Hydro Service w/ 25' Plug In Cord
(1) Exterior GFCI Receptacle @ Patio Door
(1) Exterior Coach @ Entrance Door - White
LED Track Light w/ (3) Heads in Kitchen - 70315WH
LED Reading Light @ Each Night Stand - Palo
LED Vanity Light - Bathroom - Edda
LED Pan Lighting Remaining Unit - Parkdale/Gilda
Decora Receptacles & Light Switches Throughout

Plumbing

Uponor Propex - Polyethylene Water Lines
ABS Drainage/ Waste Pipes
16GAL LP Water Heater w/ DSI Ignition & Lighted Switch
Water Heater By-Pass & Low Point Drain

Kitchen & Appliances

Black 5.8cuft Self Cleaning Gas Range - JCGBS60DEKBB
Black Combination OTR Microwave - JVM1630BFC
Black 16cuft Refrigerator - GTE16GTHBB
Laminate Countertops w/ Snap Edge Finish
Double Compartment Stainless Steel Sink
Polished Chrome Single Lever Faucet - Infinity
Box Style Modular Cabinets
Thermofoil Cabinet Doors w/ Hidden Hinges
Thermofoil Cabinet Doors w/ Soft Close Glides
Satin Nickel Cabinet Door Handles - 3128 SN

Bathroom Fixtures

Box Style Modular Cabinets w/ Porcelain Sink
54" Moulded Fiberglass Tub/ Shower
Polished Chrome Diverter, Tub Faucet & Shower Head
Polished Chrome Vanity Faucet - Kai
Polished Chrome Shower Rod w/ Curtain
1.6Gal Low Flush Toilet w/ Insulated Tank - White
70CFM Exhaust Fan
Polished Chrome Towel Bar & Tissue Holder
Polished Chrome Towel Rack Above Toilet
GFCI Receptacle @ Vanity
Medicine Cabinet w/ Mirror On Door

Bedroom Accessories

Wardrobe Closets w/ Drawers & Mirror Doors - MBR
Drawers Below Bottom Bunk - BD#2 & BD#3
6" Foam Mattresses On All Bunks

Interior Décor

2"x3" Interior Wall Construction on 16" Centres
Vinyl Wrapped Drywall Ceiling Throughout
White Colonist Interior Doors Throughout
Satin Nickel Door Knob Hardware Throughout
Durable Woodgrain Vinyl Flooring Throughout
Custom Designed Drapery Throughout - "Single Pleat"
Day/ Night Shades Throughout Unit
Pre-finished White Wire Shelving/ Closet Rod
3/4" Door & Window Jambs Throughout
1 1/2" Door & Window Casing Throughout
3) Cabinet Colour Options Available
(5) Interior Décor Packages Available

Exterior Finishes

GENTEK D-5 Vinyl Siding - Driftwood Finish
Colonial Style Shutters - Front End Wall & Door Side
White Vinyl Soffit & Aluminum Fascia
30Yr Architectural Fiberglass Shingles



Millerton - 19 (M3812 1BR FL) 460 SQ.FT.



Millerton 2 - 19 (M4412 2BR FL) 537 SQ.FT.

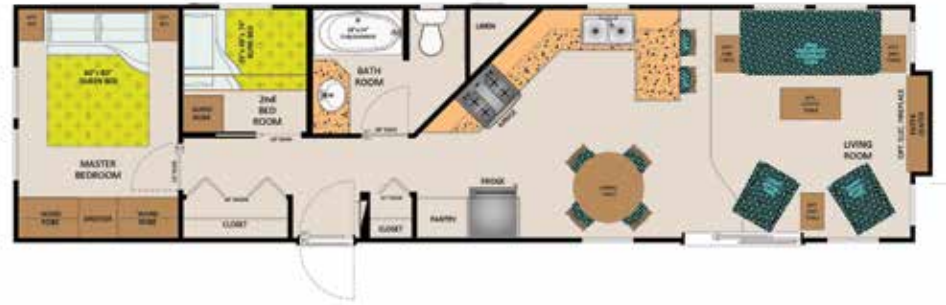

Middleton - 19 (M4212 1BR FL) 515 SQ.FT.



Melrose - 119 (M3914 2BR FL) 540 SQ.FT.



Maricourt - 19 (M3312 1BR) 379 SQ.FT.



Minniset - 19 (4113 2BR FK) 537 SQ.FT.



Manchester - 19 (M4012 1BR FL) 491 SQ.FT.



Manchester 2 - 19 (M4512 2BR FL) 539.5 SQ.FT.



Moncton - 19 (M4213 2BR FL) 533 SQ.FT.



Melbourne - 19 (M4312 2BR) 534.5 SQ.FT.



Mirabel - 19 (M4113 2BR CK) 540 SQ.FT.



McKeller - 19 (M4113 3BR FL) 539 SQ.FT.

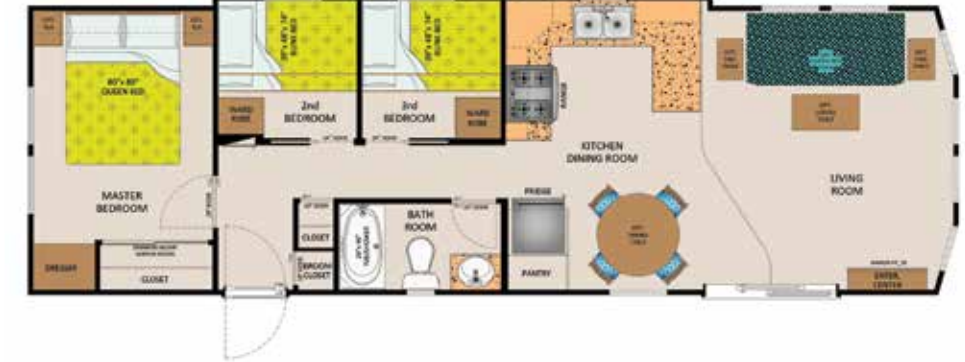

Maitland - 19 (M4012 2BR FL) 481 SQ.FT.



Mariott - 19 (M4213 2BR) 536 SQ.FT.

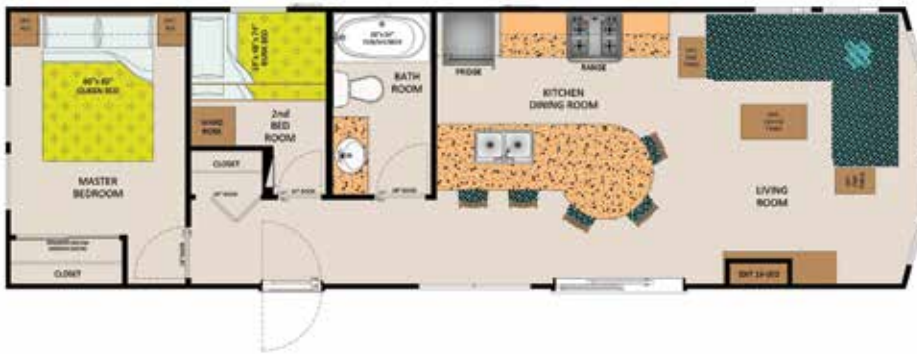

Martensville - 19 (M4213 2BR) 533 SQ.FT.



Muskoka - 19 (F3612 BR FK) 426 SQ.FT. + 213 SQ.FT.



Madison - 19 (M3914 3BR CK) 530 SQ.FT.



Marbella - 19 (M3914 2BR FL) 539 SQ.FT. + 213 SQ.FT.



Monaco - 19 (M4113 3BR FL) 539 SQ.FT. + 296.8 SQ.FT.



Maidstone - 19 (F3712 2BR FD) 438 SQ.FT. + 213 SQ.FT.



Malibu - 19 (M4113 3BR FL) 539 SQ.FT. + 232.5 SQ.FT.



FRONTIER SERIES



Décor packages.

The Frontier series has 10 great décor variations to choose from featuring amazing woodgrain vinyl flooring, coordinating

The Home Away From Home

The spacious **FRONTIER** series is designed to meet your family's needs along with offering exceptional value without compromising great looks. The Frontier series makes that dream an easy reality.

STANDARD FRONTIER SERIES FEATURES

- Modular Cabinets throughout
- Themofoil Cabinet doors
- Contemporary Cabinet Hardware Pulls
- Fully Furnished with Canadian made furniture
- Bedding, toss pillows and draperies included
- Powder coated steel bunk rail & ladder
- Day/ Night shades throughout
- Black appliances including fridge, stove & OTR microwave
- LED lighting

OPTIONAL FRONTIER FEATURES

- Ceramic Tile Backsplash
- Raised Dormers and Transom Windows
- Ceiling fan with light
- Electric Fireplace
- Air Conditioning
- Stainless Steel Appliances



window valances and standard day-night shades. Each of the floor plans in the Frontier line is designed to provide ample living space for you and your family.

FRONTIER SERIES



Construction

90" Exterior Sidewall Height
2"x3" Exterior Wall Studding On 16" Centres - R8
2"x8" Transverse Floor Joists on 16" Centres - R12
3/4" T&G Plywood Subfloor Glued & Screwed
4/12 Roof Pitch w/ Engineered Roof Trusses - R12
7/16 OSB Roof Sheathing w/ 15lb Felt Paper
10" Vented Soffit Overhang w/ 2"x6" Fascia Board

Windows & Doors

White Single Hung Vinyl Thermopane Windows - No Grills
White (6') Vinyl Thermopane Patio Door - No Grills
Insulated Aluminum Exterior Door w/ Window - (32")
Aluminum Storm Door w/ Screen - (32")

Heating & Cooling

40,000BTU Forced Air Furnace w/ Electronic Ignition
Analog Wall Mount Thermostat
Heat Duct & Registers Within Insulated Floor Cavity
Prep Only For Basement Air Conditioning Unit

Electrical

30AMP Hydro Service w/ 25' Plug In Cord
(1) Exterior GFCI Receptacle @ Patio Door
(1) Exterior Coach @ Entrance Door - White
Pewter Track Light w/ (2) Heads in Kitchen - RUE Series
LED Pan Lighting Throughout Unit - Parkdale
Decora Receptacles & Light Switches Throughout

Plumbing

Uponor Propex - polyethylene Water Lines
ABS Drainage/ Waste Pipes
16GAL LP Water Heater w/ DSI Ignition & Lighted Switch
Water Heater By-Pass & Low Point Drain

Kitchen & Appliances

Black 5.8cuft Self Cleaning Gas Range - JCGBS60DEKBB
Black Combination OTR Microwave - JVM1630BFC
Black 16cuft Refrigerator - GTE16GTHBB
Laminate Countertops w/ T-Edge Finish
Double Compartment Stainless Steel Sink
Polished Chrome Single Lever Faucet - Infinity
Box Style Modular Cabinets
Flat Panel Cabinet Doors w/ Hidden Hinges
Flat Panel Cabinet Doors w/ Metal Roller Glides
Satin Nickel Cabinet Bar Pulls - 7096SS

Bathroom Fixtures

Box Style Modular Cabinets w/ Porcelain Sink
54" Moulded Fiberglass Tub/ Shower
Polished Chrome Diverter, Tub Faucet & Shower Head
Polished Chrome Shower Rod w/ Curtain
Polished Chrome Vanity Faucet - Kai
1.6Gal Low Flush Toilet w/ Insulated Tank - White
70CFM Exhaust Fan
Polished Chrome Towel Bar & Tissue Holder
GFCI Receptacle @ Vanity
Medicine Cabinet w/ Mirror On Door

Bedroom Accessories

Queen Built-In Bed w/ HDBD & Piston Lift Access - MBR
Queen Bedspread, Pillows, Shams & Skirt - MBR
Upgraded Overhead Cabinets - MBR
(2) Modular Night Stands w/ Open Shelf
Wardrobe Closets w/ Bi-Fold Doors - MBR
Fabric Storage Bins Below Bottom Bunk - BD#2 & BD#3
6" Spring Mattresses On All Bunks

Interior Décor

2"x3" Interior Wall Construction on 16" Centres
White Colonist Interior Doors Throughout
Satin Nickel Door Knob Hardware Throughout
Durable Woodgrain Vinyl Flooring Throughout
Custom Designed Drapery Throughout - "Roman Layer"
Day/ Night Shades Throughout Unit
Pre-finished White Wire Shelving/ Closet Rod
(3) Cabinet Colour Options Available
(5) Interior Décor Packages Available

Furniture

Queen Fabric Sofabed; Sectional (Forester)
(2) End Tables & Coffee Table - Cargo (Black Coral/Elephant)
Dinette Table w/ (4) Fabric Seat Chairs - Lauren (Black Coral/ Elephant)

Exterior Finishes

GENTEK D-5 Vinyl Siding - Driftwood Finish
Colonial Style Shutters - Front End Wall
White Vinyl Soffit & Aluminum Fascia
30Yr Architectural Fiberglass Shingles



Fontrose - 19 (F3914 2BR CK) 540 SQ.FT.



Fredericton - 19 (F3812 2BR CK) 450 SQ.FT.



Forester - 19 (F3612 2BR CD) 426 SQ.FT. + 213 SQ.FT.



Fonthill - 19 (F3714 3BR CK) 502 SQ.FT.



Florence - 19 (F3714 3BR CK) 502 SQ.FT.



Fenwick - 19 (F3812 2BR FL) 454 SQ.FT.







2019

General Coach Canada has branched out into other unique products. General Coach Canada produces the very best rental cabin in the industry, they produce theatrical units for the film industry in Great Britain and Canada, commercial offices and bathroom units, mobile homes and manufactured houses are customized and delivered to developments across the country. They produce heavy-duty travel trailers, which are designed for oil patch accommodation in Northern climates.

The philosophy is simple: *"You have to find a room where there are not a lot of people and you must have unique products. It is a lot easier to survive in business if the room is not crowded". This is a vital ingredient for success but even greater if you are a Canadian manufacturer."*

Our mission is to provide the very best products produced in Canada with attention to detail and emphasis on quality materials and workmanship. We stand by the durability, style and quality of our portable solutions and continue to look for innovative ways to redefine our industry.

General Coach Canada Warranty

1-year product warranty, factory to consumer via dealer.

5-year limited warranty for components and performance relating to structural integrity, weather penetration, electrical distribution system, plumbing and heating delivery systems, window and door performance.



All Park Models manufactured by General Coach Canada are constructed in compliance with the strict standards of the C.S.A. -Z241 Park Model Standard.

The manufacturer reserves the right to improve or modify the product, without notice or obligation, which may change materials, equipment, specifications or designs. Information contained herein is from the latest data available at the time of printing. Photographs and descriptions may contain some optional extras.



Where Life Happens

GENERALCOACHCANADA.COM



BLACK
DIAMOND
EDITION

CRESCENT
moon
COLLECTION

Roughneck
by General Coach



Citation
Canada

GENERAL COACH
CANADA

Corporate Headquarters
73 Mill Street, Hensall, Ontario N0M 1X0
855.262.2600
info@generalcoachcanada.com
www.generalcoachcanada.com

Associate
Member
Camping
In Ontario

Associate Members of



Go RVing
Canada

General Coach Canada reserves the right to improve or modify the product, which may change specifications, designs or prices. Information contained in this brochure is current at the time of printing. Photographs and descriptions may contain some standard features and some optional extras. Some options may only be available on a pre-production basis. All specifications are approximate. Not all available options are listed.

Printed in Canada