

CORPORATE HEADQUARTERS

73 Mill Street, Hensall, Ontario N0M 1X0
P: 855-262-2600 Info@generalcoachcanada.com

General Coach reserves the right to improve or modify the product, which may change specifications, designs or prices. Information contained in this brochure is current at the time of printing. Photographs and descriptions may contain some standard features and some optional extras. Some options may only be available on a pre-production basis. All specifications are approximate. Not all available options are listed.



PRINTED IN CANADA

General Coach

THE HURON RIDGE PARK MODEL LINE IS THE PERFECT CHOICE FOR ANYONE LOOKING FOR A QUALITY, AFFORDABLE LIVING SPACE OR DREAM VACATION COTTAGE.



PARK MODELS

2017



WE CREATE PRACTICAL LIVING SPACES THAT ARE
COMFORTABLE, STYLISH AND AFFORDABLE.

WHERE LIFE HAPPENS

GENERAL COACH IS A CANADIAN-OWNED FAMILY
BUSINESS WITH OVER 66 YEARS OF EXPERIENCE.
OVER THE YEARS, GENERAL COACH HAS MANUFACTURED
ALL TYPES OF RECREATIONAL VEHICLES RANGING FROM
MOTORHOMES TO TRUCK CAMPERS. TODAY OUR FOCUS
IS MORE DIALED IN, AND THE EMPHASIS ON QUALITY HAS
REMAINED ENTRENCHED IN OUR DAILY ROUTINE.
GREAT DESIGN, THE HIGHEST QUALITY MATERIALS, AND
ATTENTION TO DETAIL ARE THE HALLMARKS OF EVERY
GENERAL COACH PRODUCT. OUR ENGINEERS AND
PROFESSIONAL DECORATORS DESIGN, LAYOUT, AND
MANUFACTURE STYLISH AND PRACTICAL PARK MODELS
YOU'LL BE PROUD TO OWN. WITH EVERY UNIT MEETING
OR EXCEEDING CSA STANDARDS, IT REALLY IS A WORRY
FREE VACATION COTTAGE AND A GREAT INVESTMENT.



COMFORTABLE



Standard **RESORT** amenities include:

- Black fridge, stove & over-the-range microwave
- Custom designed draperies throughout
- Residential roll-top counters in the kitchen & bath





RESORT

LAYOUT IS A CRITICAL COMPONENT TO AN EXCEPTIONAL TRAILER. GENERAL COACH OPTIMIZES EVERY INCH OF SPACE BY CREATING A GENEROUS OPEN CONCEPT LIVING ENVIRONMENT. THE RESORT SERIES OFFERS AN ABUNDANCE OF STANDARD SINGLE AND DOUBLE WIDE PLANS TO CHOOSE FROM. STILL CAN'T FIND WHAT YOU ARE LOOKING FOR? LET US CUSTOMIZE A TRAILER TO FIT YOUR TASTE AND LIFESTYLE. WHETHER IT'S AS SIMPLE AS MOVING A WALL OR AS COMPLEX AS DESIGNING A UNIT FROM SCRATCH, OUR ENGINEERING DEPARTMENT IS UP TO THE CHALLENGE. SPECIAL TOUCHES LIKE MODULAR CABINETS, WHITE TRIM PACKAGES AND WOOD BLINDS ARE SIMPLE WAYS OF UPGRADING TO THE PARK MODEL OF YOUR DREAMS. WHILE YOU'RE AT IT WHY NOT THROW IN AN ELECTRIC FIREPLACE OR TILE BACK SPLASH TO GIVE IT THE FEELING OF HOME?



RADISSON (R4012 1BR FL) 492 SQ. FT.



RIVERVIEW (R4012 2BR FL) 493 SQ. FT.



RUSTICO 1 (R4412 1BR FL) 537 SQ. FT.



RUSTICO 2 (R4412 2BR FL) 538 SQ. FT.



RIDGETOWN 1 (R4412 1BR FL) 537 SQ. FT.



RIDGETOWN 2 (R4412 2BR FL) 537 SQ. FT.



ROCKPORT (R4512 2BR FL) 540 SQ. FT.



ROSETOWN (R4213 2BR FK) 539 SQ. FT.



RAVENWOOD (R4213 2BR 2BATH) 540 SQ. FT.



RIVERSIDE (R4213) 540 SQ. FT.



RENFREW (R3914 2BR FL) 540 SQ. FT.



ROSEDALE (R3914 2BR FL) 540 SQ. FT.



REVELSTOKE (R3914 2BR FLD) 538 SQ. FT.



ROSEMÈRE (R4214) 538 SQ. FT.



RED DEER (R4113) 536+130 SQ. FT.



ROCKCLIFFE (R4124) 488+240 SQ. FT.



RESOLUTE (R4124) 492+240 SQ. FT.



RAYMORE (R4024) 480+480 SQ. FT.



RALSTON (R4224) 503+506 SQ. FT.



RATHBURN (R4524) 540+540 SQ. FT.



Download a PDF of any floor Plan at, WWW.GENERALCOACHCANADA.COM

STYLISH



Standard **MANOR** amenities include:

- Raised panel oak cabinet doors & drawers
- Vaulted drywall ceilings throughout
- Laminate kitchen & bath counter with snap edge
- Day/night shade blinds throughout





MANOR

GENERAL COACH BUILDS LIFESTYLE. WITH OPEN CONCEPT KITCHENS AND SPACIOUS LIVING ROOMS AWASH IN NATURAL LIGHT, GENERAL COACH PARK MODELS HAVE ALL THE COMFORTS YOU EXPECT IN A HOME. OUR PROFESSIONAL INTERIOR DESIGN TEAM UTILIZES STUNNING COLOUR AND FABRIC COMBINATIONS THAT REFLECT TODAY'S TRENDS TO CREATE A DÉCOR THAT SUITS YOUR STYLE. OUR MODELS BOAST A SUPERBLY APPOINTED KITCHEN, FUNCTIONAL BATHROOM, COMFORTABLE BEDROOMS, AND STYLISH LIVING AND DINING AREAS. WE CREATE PRACTICAL LIVING SPACES THAT ARE AFFORDABLE, MODERN, AND EASY TO MAINTAIN.



MILLERTON 2 -17 (M4412 1BR FL) 531 SQ. FT.



MAPLETON - 17 (M4012 1BR DEN) 481 SQ. FT.



MANCHESTER 1-17 (M4012 1BR 1BR) 491 SQ. FT.



MAITLAND -17 (M4012 2BR FL) 481 SQ. FT.



MacKENZIE (M4312 2BR FL) 507 SQ. FT.



MANITOBA - 17 (M4412 2BR FL) 521 SQ. FT.



MONCTON - 17 (M4213 BR FL) 533 SQ. FT.



McKELLER - 17 (M4113 3BR FL) 539 SQ. FT.



MARTENSVILLE - 17 (M4213 2BR) 533 SQ. FT.



MILLERTON 1 - 17 (M3812 1BR FL) 467 SQ. FT.



MANCHESTER 2 - 17 (R4012 1BR FL) 491 SQ. FT.



MELBOURNE - 17 (M4512) 527 SQ. FT.



Download a PDF of any floor Plan at, WWW.GENERALCOACHCANADA.COM

MILLBROOK - 17 (M3914 2BR FL) 530 SQ. FT.

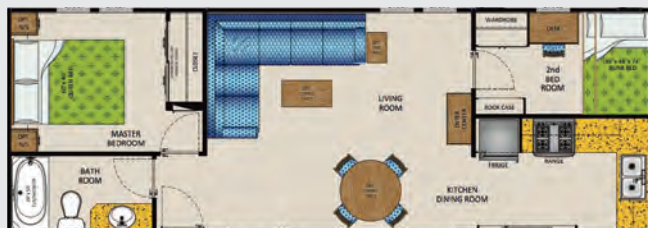

MELROSE - 17 (M3914 2BR FL) 540 SQ. FT.



MARBELLA (M3914 3BR CK) 530 SQ. FT.



MADISON - 17 (M3914 3BR CK) 530 SQ. FT.



Download a PDF of any floor Plan at, WWW.GENERALCOACHCANADA.COM

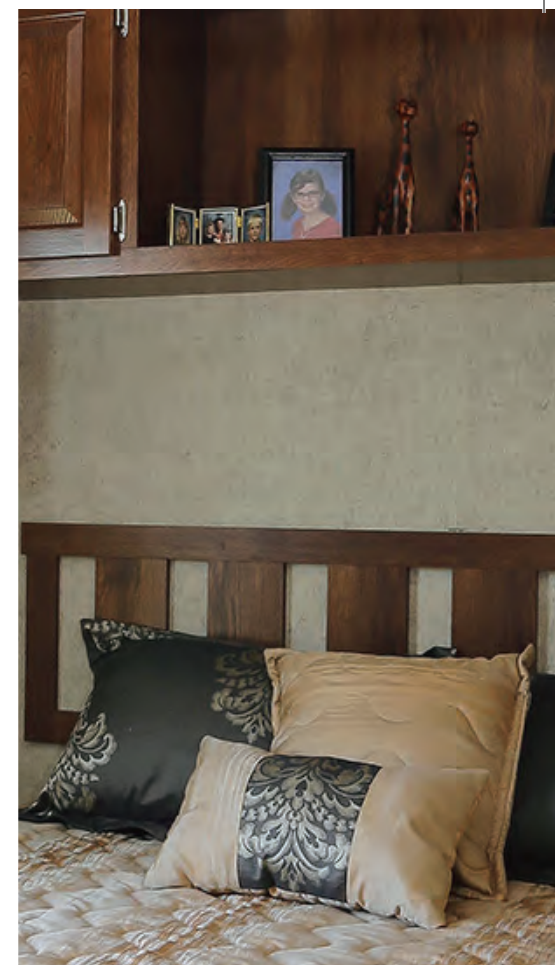

AFFORDABLE



FRONTIER

THERE'S NO NEED TO COMPROMISE QUALITY OR COMFORT IN THIS ECONOMICAL YET SPACIOUS MODEL. THE FRONTIER SERIES IS DESIGNED TO MEET YOUR NEEDS WHILE INTEGRATING KEY FEATURES. VAULTED CEILINGS, SUPERIOR WOODGRAIN VINYL FLOORING THROUGHOUT AND ELEGANT FURNISHINGS ALL ADD TO THE LUXURIOUS FEELING WHEN YOU WALK THROUGH THE DOOR. WE UNDERSTAND TRAILERS USE SPACE DIFFERENTLY THAN CONVENTIONAL HOMES, WHICH IS WHY WE PRIDE OURSELVES IN OPTIMIZING EVERY INCH OF SPACE. WHETHER IT'S INTEGRATING FABRIC BINS AT THE BASE OF BUNK BEDS OR A PISTON LIFT BED FRAME IN THE MASTER BEDROOM, THERE IS ALWAYS ROOM FOR MORE. THE FRONTIER SERIES IS OUR MOST AFFORDABLE LINE OF PARK MODELS, AND IS AVAILABLE IN SEVERAL FLOOR PLANS INCLUDING THREE SUNROOM ADDITION PLANS. YOU WILL FIND THE SAME SPACIOUS, OPEN DESIGN COMMON TO ALL GENERAL COACH PARK MODELS.

FREEPORT (F3012 1BR FL) 355 SQ. FT.



FAIRBANK (F3612 1BR FL) 426 SQ. FT.



FENWICK (F3812 2BR FL) 454 SQ. FT.



FOXBORO (F3612 1BR FL) 426 SQ. FT.



FREDERICTON (F3812 2BR CK) 450 SQ. FT.



FONTHILL (F3614 2BR CK) 489 SQ. FT.



Download a PDF of any floor Plan at, WWW.GENERALCOACHCANADA.COM

FLORENCE (F3614 3BR CK) 489 SQ. FT.



FALKLAND (F4012 2BR FL) 474 SQ. FT.



FAIRFORD (F4312) 504 SQ. FT.



FERNDALE (F3612 2BR FD) 426+213 SQ. FT.



FORESTER (F3612 2BR CD) 426+213 SQ. FT.



FERGUS (F3412 2BR FK) 402+213 SQ. FT.



DETAILS



DEDICATED EFFORT GOES INTO EVERY PARK MODEL WE BUILD.

IT'S TRULY THE LITTLE THINGS THAT MAKE THE DIFFERENCE

OUR CRAFTSMEN PRIDE THEMSELVES ON BEING THE BEST AT WHAT THEY DO. IT'S PART OF OUR COMMITMENT TO PRODUCING THE HIGHEST QUALITY PRODUCT. THAT IS WHAT MAKES GENERAL COACH CANADA #1 IN THE PARK MODEL INDUSTRY. STANDARD FEATURES ARE PLENTIFUL IN ALL OF OUR HURON RIDGE PARK MODELS, BUT WE DON'T STOP THERE. WE OFFER SEEMINGLY ENDLESS OPTIONS TO CUSTOMIZE YOUR UNIT.

Popular optional items

- Solid surface countertops with undermount sink
 - Stainless steel appliances
- Solid pine interior doors (stained to match)
 - On-demand tankless water heater
 - 56,000 BTU forced air furnace
 - Central air conditioning unit
 - Commercial grade metal roof
 - Canexel exterior siding
- The All Season winter package



RESORT (STANDARD SPECIFICATIONS)

Windows & Doors

Thermopane Vinyl Windows w/ Prairie Grills
Day/Night Fabric Shades Throughout
Dashwood Vinyl Patio Door w/ Prairie Grills
Dashwood Fiberglass Exterior Door w/
Decorative Glass – 34"x 82"
1 ½" Aluminum Storm Door w/ Screen
Grommet Style Drapery w/ Tie Back @ Patio Door
Custom Designed Valance Draperies Throughout
Colonial Shutters Standard – Front, Rear & Door Side
WHITE Colonist Interior Doors Throughout
Rubbed Bronze Hinges & Handles – All Doors

Plumbing

Uponor ProPEX Polyethylene Water Lines
ABS Drainage/Waste Pipes Throughout
25 GAL Electric Water Heater
Water Heater By-Pass
Shut-off Valves @ Toilet & Kitchen Sink

Heating/ cooling

40,000 BTU Forced Air LP Furnace w/ Electronic Ignition (56,000
BTU included if pictured)
Digital Thermostat (Non-programmable)
Heat Duct & Registers Within Insulated Floor Cavity
Safe-T-Alert gas alarm
Prep Only For Basement Air Conditioner

Electrical

50 AMP Hydro Service w/ 25' Plug In Cord
Exterior GFCI Weatherproof Receptacle @Patio Door
Exterior Coach Light @ Patio Door & Entrance Door
Oil Rubbed Bronze (3) Head Track Light In Kitchen
Oil Rubbed Bronze Ceiling Fan In Living Room
Chandelier Style Light Over Dining Area
Pendant Lights (2) Over Bar Overhang or Island (I.A.)
Decora Style Receptacles & Light Switches

Kitchen

BLACK 30" LP Range w/ Clock
BLACK 16CF Top Freezer Refrigerator
BLACK Combination Rangehood/ Microwave
Residential Roll Top Countertops – Vintage Profile
Stainless Steel Double Compartment Sink
Single Lever Chrome Faucet
Ball Bearing Drawer Hardware Throughout
Face Framed Cabinetry - Screw Nailed
Solid Ash Raised Panel Cabinet Doors & Drawers
Soft Close Hidden Hinges w/ SS Tubular Pulls

Bathroom

54" Fiberglass Tub Shower (60" in one bedroom units)
Chrome Single Lever Bath Taps w/ Rain Showerhead
Curved Steel Shower Rod w/ Curtain
1.6 GAL Low Flush Residential Toilet w/ Insulated Tank (White)
90CFM AIR KING Quiet Exhaust Fan
GFCI Receptacle @ Bath Vanity
Chrome Single Lever Vanity Faucet
Deluxe Medicine Cabinet w/ Mirror
Deluxe Towel Rack & Tissue Holder
Mirolin Neo-Angle Showers Standard In Applicable Floor Plans

Bedrooms

Wardrobe Closet w/ Mirror Doors & Dresser – MBR
Deluxe Overhead Cabinets w/ Frosted Doors - MBR
6" Foam Mattress On All Bunks
Painted Steel Railing & Ladder – Bunks
Drawers Below Bottom Bunk - BR #2 &/or BR #3
Wardrobe Cabinet w/ Drawers & Doors – Bunks

Interior

Plush Carpet In Living Room & Bedrooms
Durable Vinyl Flooring Kitchen, Hallway & Bath
¾" Door and Window Jambs Throughout
2 ¼" Door and Window Casings Throughout
Toe Kick On All Base Cabinets In Kitchen & Bath
2 ¼" Crown Moulding Over Kitchen Cabinets
Upgraded Window Coverings Throughout
Vinyl Wrapped Drywall Ceiling Throughout w/ Vapour Barrier
Pre-finished White Wire Shelving/Closet Rod
1 ½" Baseboard Moulding Living Room & Kitchen

Construction

Plush Carpet In Living Room & Bedrooms
Durable Vinyl Flooring Kitchen, Hallway & Bath
¾" Door and Window Jambs Throughout
2 ¼" Door and Window Casings Throughout
Toe Kick On All Base Cabinets In Kitchen & Bath
2 ¼" Crown Moulding Over Kitchen Cabinets
Upgraded Window Coverings Throughout
Vinyl Wrapped Drywall Ceiling Throughout w/ Vapour Barrier
1 ½" Baseboard Moulding Living Room & Kitchen

ADDITIONAL OPTIONS AVAILABLE, CONTACT US FOR DETAILS



MANOR (STANDARD SPECIFICATIONS)

Windows & Doors

Thermopane Vinyl Windows w/ Colonial Grills
 Thermopane Vinyl Patio Door w/ Vertical Blind – No Grills
 Insulated Steel Exterior Door w/ 22"x 9" Window – 32"x 80"
 1" Aluminum Storm Door w/ Screen
 ¾" Door And Window Jambs
 1 ½" Door And Window Casing

Plumbing

Uponor ProPEX Polyethylene Water Lines
 ABS Drainage/ Waste Pipes Throughout
 10 GAL LP Fast Recovery Water Heater
 Water Heater By-Pass

Heating/ cooling

40,000 BTU Forced Air LP Furnace w/ Electronic Ignition
 Wall Thermostat
 Heat Duct & Registers Within Insulated Floor Cavity
 Prep Only For Basement Air Conditioner
 Safe-T-Alert Gas Alarm

Electrical

30 Amp Hydro Service w/ 25' Plug in Cord
 Exterior GFCI Receptacle @ Patio Door
 Exterior Coach Light @ Patio Door - WHITE
 Pewter (3) Head Track Light in Kitchen – RUE
 Pewter Single Wall Light @ Each Night Stand - RUE
 Pewter (2) Head Vanity Light – RUE
 Pewter Stem Light (LR, MBR & DEN) - RUE
 Decora Style Receptacles & Light Switches

Kitchen

30" LP Range With Clock – BLACK
 16 CF Refrigerator Top Freezer - BLACK
 Combination Microwave/ Rangehood - BLACK
 Laminate Kitchen Counter With Snap Edge
 Double Compartment Stainless Steel Sink
 Single Lever Chrome Faucet
 Roller Guide Drawer Hardware Throughout
 Custom Designed Face Framed Cabinetry - Screw Nailed
 Solid Ash Raised Panel Cabinet Doors & Drawers
 Hidden Hinges w/ Pewter Pulls Throughout
 Crown Moulding Over Kitchen Cabinets

Bathroom

54" Moulded Fiberglass Tub/Shower
 Curved Shower Rod With Curtain
 1.6 gal Low Flush Residential Toilet w/ Insulated Tank (White)
 70 cfm Exhaust Fan - Baths
 GFCI Receptacle @ Vanity - Baths
 Deluxe Medicine Cabinet With Mirror
 Deluxe Towel Rack & Tissue Holder

Bedrooms

Wardrobe Closet w/ Mirror Doors & Side Dresser Master Bedroom
 5" Foam Mattress On All Bunks
 Drawers Below Bottom Bunk - BR #2 &/or BR #3

Interior

Plush Carpet in Living Room & Master Bedroom
 Durable Vinyl Flooring Kitchen, Hallway & BR#2/BR#3
 Pre-finished White 6 Panel Colonial Interior Doors
 w/ Pewter Handles
 Custom Designed Coordinated Drapery Throughout
 Vinyl Wrapped Drywall Ceiling Throughout
 Pre-finished White Wire Shelving/Closet Rod

Construction

90" Sidewall Height
 2"x 3" Wall Studding on 16" Centres – R8
 2"x 8" Transverse Floor Joists on 16" Centres – R12
 ¾" T&G Plywood Subfloor Glued & Screwed
 4/ 12 Roof Pitch w/ Engineered Roof Trusses – R12
 7/16" OSB Roof Sheathing w/ 30 Year Fiberglass Shingles
 10" Vented Soffit With 2"x 6" Fascia Board
 ¼" OSB Exterior Sheathing With Building Wrap

ADDITIONAL OPTIONS AVAILABLE, CONTACT US FOR DETAILS

FRONTIER (STANDARD SPECIFICATIONS)

Windows & Doors

Thermopane Vinyl Windows Throughout – NO Grills
Thermopane Vinyl Patio Door With Vertical Blind 72"x 80" – NO Grills
Insulated Aluminum Exterior Door With Window 32"x 80"
¾" Window And Door Jambs
1" Aluminum Storm Door With Screen

Plumbing

Uponor ProPex - Polyethylene Water Lines
ABS Drainage/Waste Pipes
Water Heater By-pass
10 Gal LP Fast Recovery Water Heater

Heating/ cooling

40,000BTU Forced Air LP Furnace w/ Electronic Ignition
Wall Thermostat
Heat Duct & Registers Within Insulated Floor Cavity
Prep Only For Basement Air Conditioner

Electrical

30 Amp Hydro Service With 25' Plug in Cord
Exterior GFCI Receptacle @ Patio Door
Exterior Coach Light @ Entrance Door - WHITE
Pewter (2) Head Track Light in Kitchen - RUE
Pewter Pan Lighting Throughout Unit
Decora Style Receptacles & Light Switches Throughout

Kitchen

Laminate Kitchen Counter w/ T-Edge
Double Compartment Stainless Steel Sink
Single Lever Chrome Faucet
30" LP Range – BLACK
16CF Refrigerator Top Freezer - BLACK
Deluxe (2) Speed Rangehood w/ Light - BLACK
Roller Guide Drawer Hardware Throughout
Custom Designed Face Framed Cabinetry Screw Nailed
Solid Ash Raised Panel Cabinet Doors & Drawers
Surface Mount Pewter Hinges with Pulls
Crown Moulding Over Kitchen Cabinets

Bathroom

Factory Built Vanity With Porcelain Sink
54" Moulded Fiberglass Tub/Shower
Shower Rod With Curtain
1.6gal Low Flush Residential Toilet With Insulated Tank - WHITE
70 cfm Exhaust Fan
GFCI Receptacle at Vanity - Baths
Medicine Cabinet With Mirror - Baths
Towel Bar & Tissue Holder

Bedrooms

(1) Night Stand in Master Bedroom
Wardrobe Closet with Mirror Doors & Side Dresser in Master Bedroom
5" Foam Mattress on All Bunks
Fabric Storage Bins Below Bottom Bunk BR #2/BR #3

Interior

Durable Woodgrain Vinyl Flooring Throughout
2"x 3" Wall Studding on 16" Centres Throughout
Pre-Finished White 6 Panel Colonial Interior Doors With Pewter Handles
Custom Designed Coordinating Drapery Throughout
"Oiled Oak" or "Walnut" Cabinetry Standard Throughout
Pre-finished White Wire Shelving/Closet Rod

Construction

90" Sidewall Height
2"x 3" Wall Studding on 16" centres – R8
2"x 8" Transverse Floor Joists on 16" Centres – R12
¾" T&G Plywood Subfloor Glued & Screwed
4/ 12 Roof Pitch w/ Engineered Roof Trusses – R12
7/16" OSB Roof Sheathing with 30 Year Fiberglass Shingles
10" Vented Soffit with 2"x6" Fascia Board

General Coach Canada Warranty

- 1-year factory to consumer product warranty
- 5-year limited warranty for components and performance relating to structural integrity, weather penetration, electrical distribution system, plumbing and heating delivery systems, window and door performance



All Park Models manufactured by General Coach Canada are constructed in compliance with the stringent standards of the C.S.A.-Z241 Park Model Recreational Vehicle Standard.

ADDITIONAL OPTIONS AVAILABLE, CONTACT US FOR DETAILS

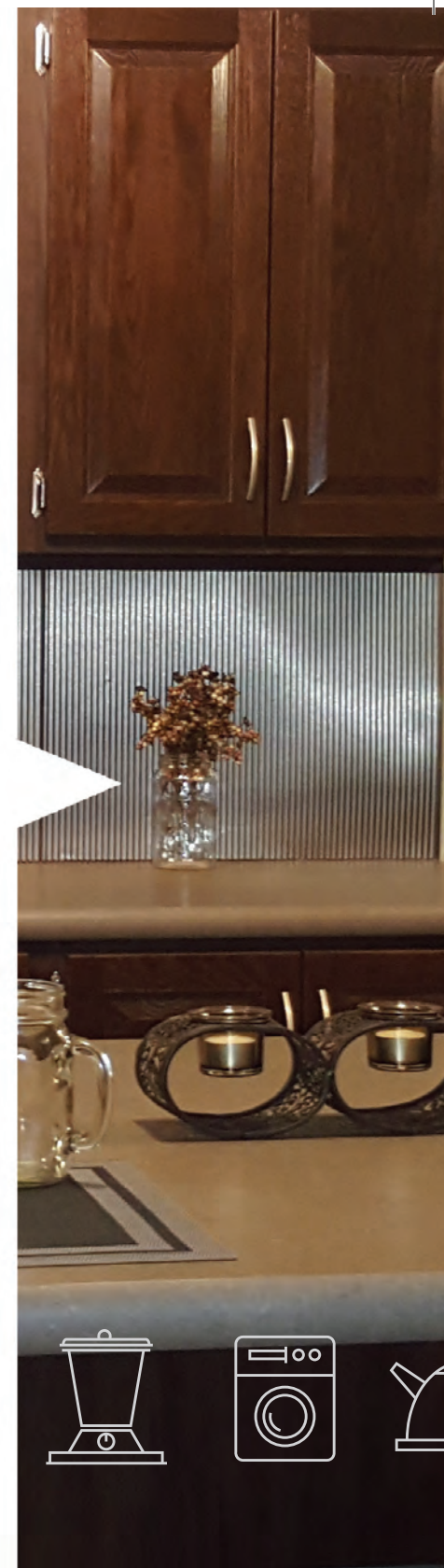
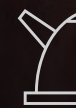
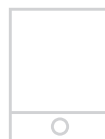



RESORT



MANOR



FRONTIER

generalcoachcanada.com
INFO@GENERALCOACHCANADA.COM

